

Lyon County 4-H Club Day

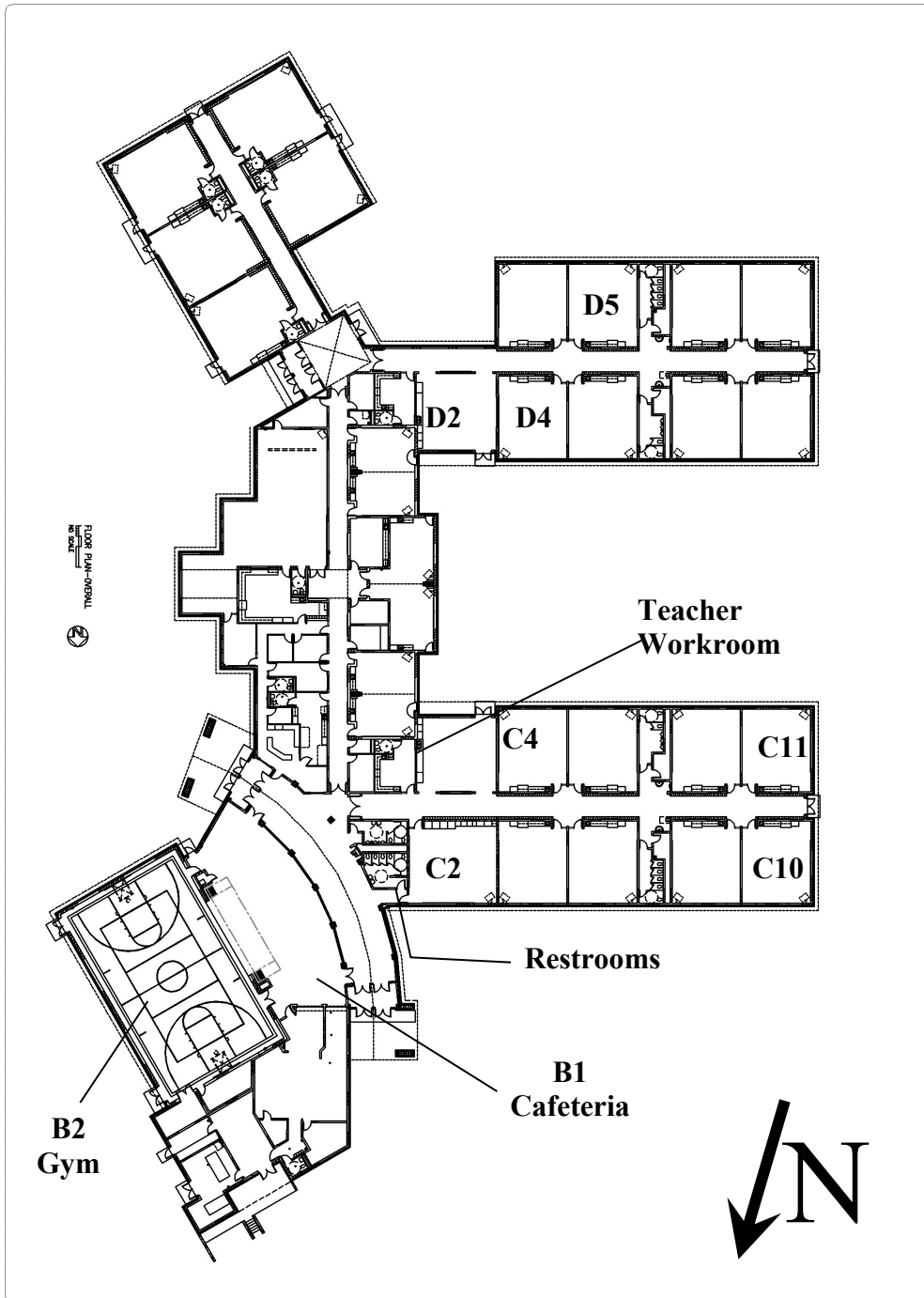

March 2, 2019
Timmerman School



READINGS		
Time Limit: Not to Exceed 5 minutes		
Regional Entry: 1		
Room: C4	Club: Chamness	
9:00	Joanna Miller	RS
9:05	Kylee Barr	RD
9:10	Emmalie Bess	BB
9:15	Marley Heins	HH
9:20		
9:25	Esther Davis	MB
9:30	Caden Jackson	RD
9:35	Taylor Pringle	RS
9:40	McKinley Senft	RD
9:45	Kerstyn Fox	RD
9:50	Sophia Hill	CL
9:55	Addison Marshall	CL
10:00	Dane Kuhlmann	HH
10:05	Kyla Kuhlmann	HH
10:10	Hunter McCoy	MB
10:15	Jade Wilson	BB
10:20	Brooke Marshall	CL
10:25	Owen DeDonder	RS
10:30	Andi DeDonder	RS
10:35	Leo DeDonder	RS
10:40	Luke Marshall	CL
10:45	Ella Davidson	RK
10:50	Carter Davidson	RK

February 14, 2019

JUNIOR DEMONSTRATIONS Time Limit: 10 minutes Regional Entry: 2		
Room: C10		Club: Model Boosters
9:00	Ava Matile	SF
9:10	Mason Jenkins	RS
9:20	Madison Jenkins	RS
9:30	Blake Redeker	HH
9:40	Morgan McCoy	MB
9:50	Kylee Barr	RD
10:00	Wyatt Miser	MB
10:10	Isaac Miller	CH
10:20	MaKenna Hoelting	HH
10:30	Brooke Marshall	CL
10:40	Chloe Fischer	CL
10:50	Rees Spade	CL
11:00	Clara Traffanstedt	CH
11:10	Isaac Knuth	CH
11:20	Emily Storrer	LA
11:30	Rose Catterson	LA
11:40	Emily Miser	MB

Dear 4-H Members and Parents:

I know you are all anxiously awaiting the Lyon County 4-H Club Day Event. As you know, this event will be taking place on March 2, 2019 at Timmerman School. Timmerman School is located at 2901 Timmerman Drive. Directions are as follows: from Highway 50, take Graphic Arts north to 30th Ave. Make a right turn onto 30th Ave. Timmerman School will be on your right.

As always, it is important to know that the actions of every individual, youth and adult are noticed. It is important to leave everything in its place and the way it was when we got there. If you have to move something for the contest, make sure it gets back to the proper place. We currently have a good working relationship with this school and we need your help to keep it that way.

In addition to the times and events listed in this program, the Club Day Guidelines are also included. If you have any questions about these guidelines, do not hesitate to give me a call at the office (341-3220).

A central meeting point for this event will be the cafeteria (B1). You will be able to set up times to meet with your gavel games team, demonstration partner, parents or child(ren), etc. A map of the school is also included in this program booklet to help you know where you need to go for the various contests.

We have tried to ensure that there are no scheduling conflicts, but unfortunately we may not have caught them all. When you arrive at club day and you find that there is a conflict, be sure to let the room monitor(s) know. **Please make sure the room monitor(s) know ahead of your scheduled time.** We are flexible and can work around scheduling conflicts, but if you do not let the room monitor(s) know prior to your scheduled time that you are there, they may put you down as a “no show.” We want to ensure that you have the opportunity to compete in the contests you desire.

If there are any changes to the program between now and the day of Club Days, they will be posted outside of the room in which the event(s) will be occurring. A master copy of the schedule will also be placed there. Results will be posted on the windows located by the cafeteria.

Best of luck to all 4-H members participating in 4-H Club Day. Whether you are giving a talk or demonstration or playing an instrument, **remember to have fun.**

See you at 4-H Club Day!

Corinne Patterson
County Extension Agent
4-H Youth Development

4-H DAY GUIDELINES

PUBLIC PRESENTATIONS

The primary purpose of the 4-H program is to help each boy and girl reach his or her maximum growth and development, and it is this area that public presentations makes its greatest contributions.

Public presentations help strengthen the 4-H program by giving members the opportunity to participate. The more often members are involved in demonstrations, project talks and public speaking, the more interested they become in meetings and in project work; consequently, the longer they remain in 4-H work.

Public presentations contribute to helping youth achieve the basic life skills of developing self-confidence, making decisions, communicating and relating to others, encouraging and stimulating their desire to learn. 4-H Day has long sponsored demonstration and public speaking. All are under the umbrella of "Public Presentations."

Please note that the judge's decision is final when the paperwork has been turned in on the day of the event. The judge will decide which entries move on to Regional Club Days based upon the most qualified entries.

No weapon of any kind will be allowed in the school building for 4-H Club Day.

The following is a list of public presentations and guidelines to be followed for 4-H Day:

PROJECT TALKS:

TIME LIMIT: 2 - 7 minutes

Project talks are intended for junior and intermediate 4-H'ers from 7 through 13 years of age to help them gain confidence in expressing themselves before an audience. They tell of their actual project experiences and can promote a project. The project talk must be on a project in which the 4-H'er is enrolled. Visuals may be used, but are not required. There are no team project talks.

PUBLIC SPEAKING:

TIME LIMIT: 7 - 15 minutes

Public speaking is intended to assist senior 4-H members 14 to 19 years of age to develop more confidence and skill in speaking before an audience. Presentations should be original. Visuals may be used. One or two note cards are suggested. Outlines must be provided for each judge.

READING:

TIME LIMIT: 5 minutes

This may be musical, dramatic, interpretive, humorous or other type of reading. Maximum time for readings for both junior and senior levels is 5 minutes. Use of a script is required. A copy of the script must be given to the judge. There are no team readings.

DEMONSTRATIONS:

TIME LIMIT: - 10 minutes

Demonstrations are defined as a "show how" process involving doing or making something while giving an explanation. The demonstrator uses actual items, supplies, equipment, people or animals while going through a process. There is usually a finished product to show, but it is not required. The demonstration is a teaching method designed to teach specifically. Contestants provide their own equipment and material. Demonstrations may be presented as an individual or as a team of two 4-H members. Demonstrations must highlight a project in which the 4-H'er is enrolled.

SHOW & SHARE:

TIME LIMIT: 2 minutes

This division is for first time 4-H'ers to give a talk about any 4-H related project or item. Props or poster may be used. This is a noncompetitive event and every 4-H'er will receive a ribbon. An evaluator will be in the room to give 4-H'er's positive comments about their talk.

TALENT

Development of the individual talents of young people have always been an objective of Kansas 4-H programs. In the performing arts, skills are only refined by repeated experience in performing them. 4-H Day provides an ideal structure to allow 4-H'ers to perform in a wide variety of areas.

JUNIOR TALKS (continued) Time Limit: 2 to 7 minutes Regional Entry: 2 Total Room: D5 Club: Reading (9:00-9:45) - Cloverleaf (9:45 - end)		
11:18	MaKenna Hoelting	HH
11:24	Daylen Ballinger	HH
11:30	Isaac Miller	CH
11:36	Madelynn Knuth	CH
11:42	Cordon Olson	MB
11:48	Bailee Van Sickle	MB
11:54	Kasen Van Sickle	MB
12:00	Rose Catterson	LA
12:06	Seth Davis	MB
12:12	Esther Davis	MB
12:18	Sophia Hill	CL

PUBLIC SPEAKING Time Limit: 7 to 15 minutes Regional Entry: 2 Room: C11 Club: Busy Beavers		
11:00	Olivia Hamlin	CL
11:10	Ted Skalsky	BB
11:20	Emma Miller	CH
11:30	Kate Rees	CH
11:40	Riley Botkin	LA

JUNIOR TALKS

Time Limit: 2 to 7 minutes

Regional Entry: 2 Total

Room: D5 Club: Reading (9:00-9:45) - Cloverleaf (9:45 - end)

9:00	Leo DeDonder	RS
9:06	Owen DeDonder	RS
9:12	Andi DeDonder	RS
9:18	Bethany DeDonder	RS
9:24	Taylor Pringle	RS
9:30	Joanna Miller	RS
9:36	Kylee Barr	RD
9:42	Darren Heins	HH
9:48	Kinley Heins	HH
9:54	Mason Jenkins	RS
10:00	Luke Marshall	CL
10:06	Addison Marshall	CL
10:12	Clara Fischer	CL
10:18	Ava Karcher	CL
10:24	Ty Karcher	CL
10:30	Grayson Hanlin	CL
10:36	Cooper Spade	CL
10:42	Karsen McKay	CL
10:48	Korbin Reeves	RS
10:54	Landon Reeves	RS
11:00	Dilynn Reeves	RS
11:06	Jade Wilson	BB
11:12	Drew Ritchie	HH
	Continued on next page	

It is hoped that this experience will be so rewarding that members will choose to repeat their performances at the State Fair Showcase, as well as for multi-county and other state wide events.

There is no better learning experience in the performing arts than the "learning-by-doing" experience with caring feedback offered at 4-H Day.

MUSIC: Taped music is an option for accompaniment for vocals and instrumentals. If there are deviations between the presentation and the printed music, you need to note those to the judge.

Note: All music entries must bring the original sheet music for the judge and the measures need to be numbered. Vocal music participants must have their entry memorized. Instrumental music participants are not required to have their music memorized.

CHORUS:

A chorus may be composed of 11 or more 4-H'ers from one club or it may be a composite group from two or more clubs.

Each group will sing two numbers of their own choosing.

Original copy of selections will be given to judge before performing. The measures need to be numbered.

Singing may be with or without accompaniment.

The director and accompanist need not be 4-H'ers, but they cannot sing with the group unless they are 4-H'ers.

VOCAL ENSEMBLE:

Group may be composed of 2 to 10 4-H'ers, not including the accompanist. Each group will sing two numbers of their own choosing.

Original copy of selections is to be given to judge before performing. The measures need to be numbered.

Accompanist need not be a 4-H'er.

VOCAL SOLO:

Participant will sing one number.

Original copy of selection is to be given to judge before performing. The measures need to be numbered.

Accompanist need not be a 4-H'er.

Selection must be memorized.

INSTRUMENTAL ENSEMBLE:

Group may be composed of 2 to 10 4-H'ers, not including the accompanist.

Each group will play two selections of their own choosing.

Original copy of selections is to be given to judge before performing. The measures need to be numbered.

The instrumentation should include only recognized instruments of the band or orchestra.

The accompanist need not be a 4-H'er where the piano is accompaniment only, as for a trumpet trio. The pianist must be a 4-H'er when the piano is one of the instruments, as in a string trio or similar group.

INSTRUMENTAL SOLO:

4-H'er will play only one number.

Original copy of selection is to be given to judge before performing. The measures need to be numbered.

Accompanist, if needed, does not need to be a 4-H'er.

Selection is not required to be memorized.

DANCE ROUTINES:**TIME LIMIT: 5 minutes**

Group may be composed of 1 or more. Any age. 1 number.

ONE ACT PLAY/SKIT:**TIME LIMIT: 10 minutes**

Entries are limited strictly to one act plays. Only one setting is allowed.

May be rehearsed or extemporaneous. If extemporaneous, the group should be given a basic situation for the theme.

No size or age limit. Regional 4-H Day Guidelines require an original script to be presented to the judge.

NOVELTY:**TIME LIMIT: 5 minutes**

No age or size limit

EXTEMPORANEOUS**GUIDELINES:****TIME LIMIT: Jr. - 2-3 minutes and Sr. - 3-7 minutes.**

Participants will draw two of the 5 questions provided in the February/March Newsletter and he or she will pick which question he or she wants to answer. The participant will inform the judge of his or her question and will then provide an answer. The judge is permitted to ask questions. No regional entry.

GAVEL GAMES

The 4-H Gavel Game is an activity designed to encourage youth to become more efficient in their ability to use parliamentary procedure effectively in the formal part of their 4-H club meetings.

GUIDELINES:**TIME LIMIT: 10 - 15 minutes**

1. This contest will consist of teams of four 4-H'ers: President, Vice President, Secretary and Treasurer.
2. Each team member will take a written test worth 30 points.
3. The division levels will be divided as Junior (7 to 13 years) and Senior (14 to 19 years). Each division will be judged on their parliamentary skills. If one or more 4-H'ers are in the Senior division, the team must enter as a Senior team.
4. Junior & Seniors levels may not use an order of business or notes.
5. Senior level **will** draw for Officer assignments. Junior level **will not** draw for Officer assignments.

SENIOR DEMONONSTRATIONS		
Time Limit: 10 minutes		
Regional Entry: 2		
Room: C11		Club: Busy Beavers
9:00	Damon Redeker	HH
9:10	Viola Fritts	HH
9:20	Ashlyn Alingh	LA
9:30	Josie Orear	CH
9:40	Emma Barnett	RS
10:00	Garland Hanlin	CL
10:10	Kaylie McKay	CL
10:20	Emma Miller	CH

MODEL MEETING

The 4-H Model Meetings has been used as a device for teaching 4-H'ers proper meeting techniques. Clubs are encouraged to plan a Model Meeting that depicts a typical monthly meeting of their 4-H club. The meeting may be designed to suit the needs and interests of 4-H club members.

MODEL MEETING GUIDELINES:

The group may be composed of up to the number of 4-H members and leaders the room will hold.

An agenda of the Model Meeting must be presented to the judge before the meeting is called to order.

A maximum of thirty-five (35) minutes is allowed for a Model Meeting.

During the Model Meeting, the secretary should take notes. After the meeting, the secretary must turn in the Model Meeting notes and the up-to-date secretary's book.

Recreation may be at any time during the meeting. Some clubs prefer to have their recreation at the start of the meeting, rather than at the end.

Clubs are required to make at least one (1) motion from each of the five (5) categories of motions. The categories are: Main Motion, Subsidiary Motion, Incidental Motion, Privileged Motion, and Unclassified Motion. Motions can be found in the *A Guide to Parliamentary Practice for your club* on pages 2-3.

In addition to your club's usual meeting practices, references that may be used in planning a Model Meeting are:

The Meeting Will Come to Order - County Extension Office
Steps in 4-H Program Planning - County Extension Office
Out of Ideas? A Leaders Handbook - County Extension Office

For Model Meetings, clubs are required to make at least one (1) motion from the five (5) types of motions. This will result in a minimum total of 5 motions. The types of motions are: Main, Subsidiary, Incidental, Privileged, and Unclassified. Motions that fall under these categories/types can be found in *A Guide to Parliamentary Practice for your Club* on pages 2-3. This publication is available at the Extension Office.

All musical Entries must bring the original sheet music for the judge and have the measures numbered. **Vocal music participants must have their entry memorized. Instrumental music participants are not required to have their music memorized.**

NOTE: A piano or keyboard will be available for those participating in the instrumental and vocal music category.

The Lyon County Ambassadors will have concessions available during Club Days - snacks and drinks only.

SENIOR VOCAL SOLO Time Limit: 10 minutes Regional Entry: 1		
Room: C2		Club: Riverside
9:00	Ashlyn Alingh	LA

SENIOR INSTRUMENTAL SOLO Time Limit: Not to Exceed 5 minutes Regional Entry: 1		
Room: C2		Club: Riverside
9:05	Kate Rees	CH

JUNIOR INSTRUMENTAL SOLO Time Limit: Not to Exceed 5 minutes Regional Entry: 1		
Room: C2		Club: Riverside
9:10	Taylor Pringle	RS
9:15	Esther Davis	MB
9:20	Seth Davis	MB
9:25	Jesse Kuhlmann	HH
9:30	Kyla Kuhlmann	HH
9:35	Daden Wilson	BB
9:40	Bethany DeDonder	RS
9:45	Blake Skalsky	BB
9:50	Lilly Skalsky	BB
9:55	Alisa Skalsky	BB
10:00	Korbin Reeves	RS
10:05	Landon Reeves	RS
10:10	Dilynn Reeves	RS

JUNIOR VOCAL SOLO Time Limit: 10 minutes Regional Entry: 1		
Room: C2		Club: Riverside
10:15	Addison Wigton	BB

Club Abbreviations

Busy Beavers	BB Model Boosters	MB
Cloverleaf	CL Reading	RD
Chamness	CH Rinker	RK
Happy Harvesters	HH Riverside	RS
Logan Avenue	LA Sunflower	SF

JUNIOR GAVEL GAMES		
Time Limit: 10 to 15 minutes		
Regional Entry: 1		
Room: D4		Club: Logan Avenue
10:30	Model Boosters 1 - Morgan McCoy, Kelsey McCoy, Kinzie Kurzen & Jaiden Kurzen	
10:45	Model Boosters 2—Emily Miser, Wyatt Miser, Bailee Van Sickle & Kasen Van Sickle	

Each Gavel Game Team must report to room D2 to take the written test. Due to scheduling conflicts, this may be done before or after your Scheduled Gavel Game.

EXTEMPORANEOUS		
Time Limit: 5 minutes		
Regional Entry: 0		
Room: D4		Club: Logan Avenue
11:00	Isaac Miller	CH
11:05	Kate Rees	CH
11:10	Rose Catterson	LA

NOVELTY		
Time Limit: Not to Exceed 5 minutes		
Regional Entry: 1		
Room: B2 - Gym		Club: Happy Harvesters
10:00	Leo DeDonder & John Pringle	RS
10:10	Reading 4-H Club	RD

SHOW & SHARE		
Time Limit: Not to Exceed 2 minutes		
Regional Entry: 0		
Room: C4		Club: Chamness
10:45	Caroline Traffanstedt	CH
10:50	Rhylee Venters	RD
10:55	Lane Wilson	BB
11:00	Kayla Storrer	LA