

Lyon County 4-H Club Day

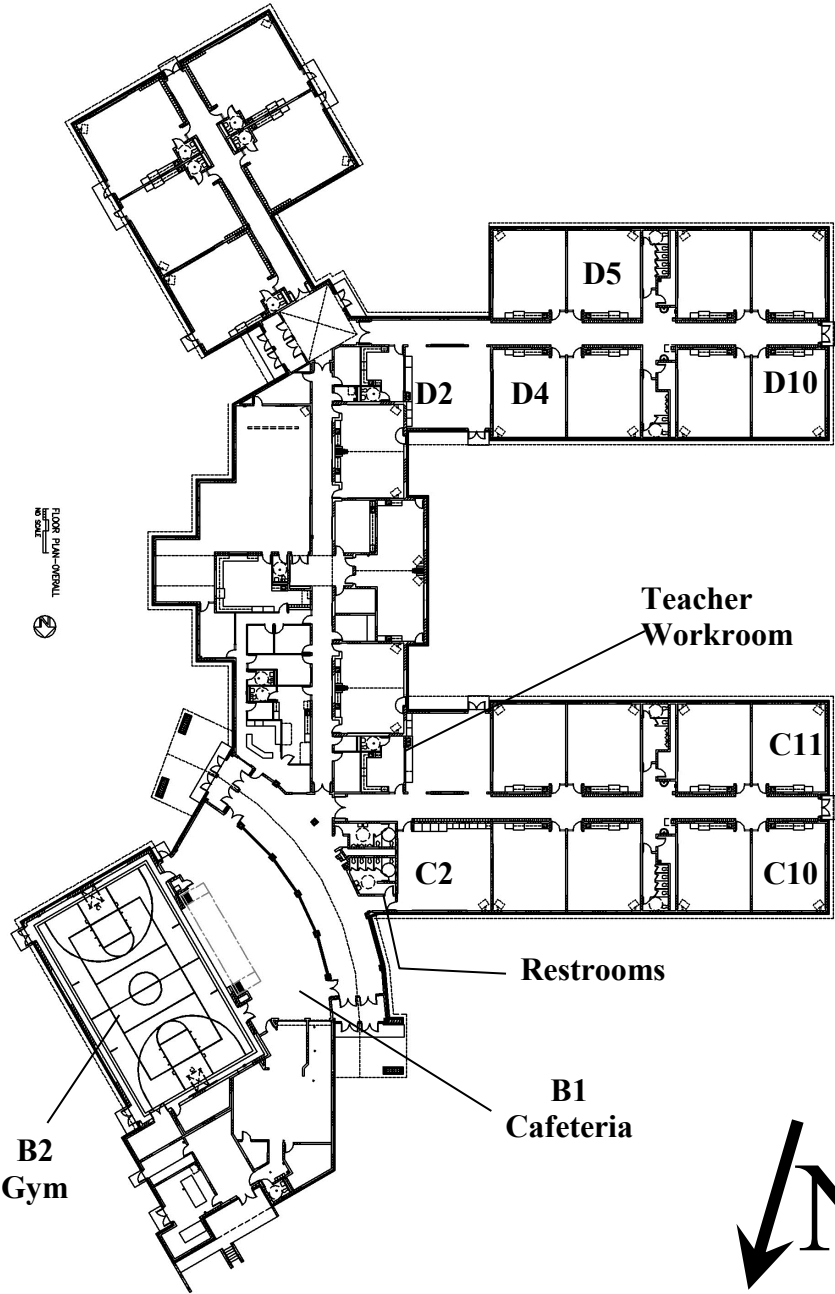

March 3, 2018
Timmerman School



FLOOR PLAN - OVERALL
 1/8" = 1'-0"

B2
 Gym

**Teacher
 Workroom**

Restrooms

B1
 Cafeteria



FLOOR PLAN - OVERALL

TIMMERMAN ELEMENTARY SCHOOL

300 Timmerman Drive
 Emporia, KS 66801

USD EMPORIA SCHOOLS
 PO Box 1005
 501 Marshall Street
 Emporia, KS 66801
 Phone: 620-341-2200

253

February 12, 2018



Dear 4-H Members and Parents:

I know you are all anxiously awaiting the Lyon County 4-H Club Day Event. As you know, this event will be taking place on March 3, 2018 at Timmerman School. Timmerman School is located at 2901 Timmerman Drive. Directions are as follows: from Highway 50, take Graphic Arts north to 30th Ave. Make a right turn onto 30th Ave. Timmerman School will be on your right.

As always, it is important to know that the actions of every individual, youth and adult are noticed. It is important to leave everything in its place and the way it was when we got there. If you have to move something for the contest, make sure it gets back to the proper place. We currently have a good working relationship with this school and we need your help to keep it that way.

In addition to the times and events listed in this program, the Club Day Guidelines are also included. If you have any questions about these guidelines, do not hesitate to give me a call at the office (341-3220).

A central meeting point for this event will be the cafeteria (B1). You will be able to set up times to meet with your gavel games team, demonstration partner, parents or child(ren), etc. A map of the school is also included in this program booklet to help you know where you need to go for the various contests.

We have tried to ensure that there are no scheduling conflicts, but unfortunately we may not have caught them all. When you arrive at club day and you find that there is a conflict, be sure to let the room monitor(s) know. **Please make sure the room monitor(s) know ahead of your scheduled time.** We are flexible and can work around scheduling conflicts, but if you do not let the room monitor(s) know prior to your scheduled time that you are there, they may put you down as a “no show.” We want to ensure that you have the opportunity to compete in the contests you desire.

If there are any changes to the program between now and the day of Club Days, they will be posted outside of the room in which the event(s) will be occurring. A master copy of the schedule will also be placed there. Results will be posted on the windows located by the cafeteria.

Best of luck to all 4-H members participating in 4-H Club Day. Whether you are giving a talk or demonstration or playing an instrument, **remember to have fun.**

See you at 4-H Club Day!

Corinne Patterson
County Extension Agent
4-H Youth Development

4-H DAY GUIDELINES

PUBLIC PRESENTATIONS

The primary purpose of the 4-H program is to help each boy and girl reach his or her maximum growth and development, and it is this area that public presentations makes its greatest contributions.

Public presentations help strengthen the 4-H program by giving members the opportunity to participate. The more often members are involved in demonstrations, project talks and public speaking, the more interested they become in meetings and in project work; consequently, the longer they remain in 4-H work.

Public presentations contribute to helping youth achieve the basic life skills of developing self-confidence, making decisions, communicating and relating to others, encouraging and stimulating their desire to learn. 4-H Day has long sponsored demonstration and public speaking. All are under the umbrella of "Public Presentations."

Please note that the judge's decision is final when the paperwork has been turned in on the day of the event. The judge will decide which entries move on to Regional Club Days based upon the most qualified entries.

No weapon of any kind will be allowed in the school building for 4-H Club Day.

The following is a list of public presentations and guidelines to be followed for 4-H Day:

PROJECT TALKS:

TIME LIMIT: 2 - 7 minutes

Project talks are intended for junior and intermediate 4-H'ers from 7 through 13 years of age to help them gain confidence in expressing themselves before an audience. They tell of their actual project experiences and can promote a project. The project talk must be on a project in which the 4-H'er is enrolled. Visuals may be used, but are not required. There are no team project talks.

PUBLIC SPEAKING:

TIME LIMIT: 7 - 15 minutes

Public speaking is intended to assist senior 4-H members 14 to 19 years of age to develop more confidence and skill in speaking before an audience. Presentations should be original. Visuals may be used. One or two note cards are suggested. Outlines must be provided for each judge.

READING:

TIME LIMIT: 5 minutes

This may be musical, dramatic, interpretive, humorous or other type of reading. Maximum time for readings for both junior and senior levels is 5 minutes. Use of a script is required. A copy of the script must be given to the judge. There are no team readings.

DEMONSTRATIONS:

TIME LIMIT: - 10 minutes

Demonstrations are defined as a "show how" process involving doing or making something while giving an explanation. The demonstrator uses actual items, supplies, equipment, people or animals while going through a process. There is usually a finished product to show, but it is not required. The demonstration is a teaching method designed to teach specifically. Contestants provide their own equipment and material. Demonstrations may be presented as an individual or as a team of two 4-H members. Demonstrations must highlight a project in which the 4-H'er is enrolled.

SHOW & SHARE:

TIME LIMIT: 2 minutes

This division is for first time 4-H'ers to give a talk about any 4-H related project or item. Props or poster may be used. This is a noncompetitive event and every 4-H'er will receive a ribbon. An evaluator will be in the room to give 4-H'er's positive comments about their talk.

TALENT

Development of the individual talents of young people have always been an objective of Kansas 4-H programs. In the performing arts, skills are only refined by repeated experience in performing them. 4-H Day provides an ideal structure to allow 4-H'ers to perform in a wide variety of areas.

It is hoped that this experience will be so rewarding that members will choose to repeat their performances at the State Fair Showcase, as well as for multi-county and other state wide events.

There is no better learning experience in the performing arts than the “learning-by-doing” experience with caring feedback offered at 4-H Day.

MUSIC: Taped music is an option for accompaniment for vocals and instrumentals. If there are deviations between the presentation and the printed music, you need to note those to the judge.

Note: All music entries must bring the original sheet music for the judge and the measures need to be numbered. Vocal music participants must have their entry memorized. Instrumental music participants are not required to have their music memorized.

CHORUS:

A chorus may be composed of 11 or more 4-H'ers from one club or it may be a composite group from two or more clubs.

Each group will sing two numbers of their own choosing.

Original copy of selections will be given to judge before performing. The measures need to be numbered.

Singing may be with or without accompaniment.

The director and accompanist need not be 4-H'ers, but they cannot sing with the group unless they are 4-H'ers.

VOCAL ENSEMBLE:

Group may be composed of 2 to 10 4-H'ers, not including the accompanist. Each group will sing two numbers of their own choosing.

Original copy of selections is to be given to judge before performing. The measures need to be numbered.

Accompanist need not be a 4-H'er.

VOCAL SOLO:

Participant will sing one number.

Original copy of selection is to be given to judge before performing. The measures need to be numbered.

Accompanist need not be a 4-H'er.

Selection must be memorized.

INSTRUMENTAL ENSEMBLE:

Group may be composed of 2 to 10 4-H'ers, not including the accompanist.

Each group will play two selections of their own choosing.

Original copy of selections is to be given to judge before performing. The measures need to be numbered.

The instrumentation should include only recognized instruments of the band or orchestra.

The accompanist need not be a 4-H'er where the piano is accompaniment only, as for a trumpet trio. The pianist must be a 4-H'er when the piano is one of the instruments, as in a string trio or similar group.

INSTRUMENTAL SOLO:

4-H'er will play only one number.

Original copy of selection is to be given to judge before performing. The measures need to be numbered.

Accompanist, if needed, does not need to be a 4-H'er.

Selection is not required to be memorized.

DANCE ROUTINES:**TIME LIMIT: 5 minutes**

Group may be composed of 1 or more. Any age. 1 number.

ONE ACT PLAY/SKIT:**TIME LIMIT: 10 minutes**

Entries are limited strictly to one act plays. Only one setting is allowed.

May be rehearsed or extemporaneous. If extemporaneous, the group should be given a basic situation for the theme.

No size or age limit. Regional 4-H Day Guidelines require an original script to be presented to the judge.

NOVELTY:**TIME LIMIT: 5 minutes**

No age or size limit

EXTEMPORANEOUS**GUIDELINES:****TIME LIMIT: Jr. - 2-3 minutes and Sr. - 3-7 minutes.**

Participants will draw two of the 5 questions provided in the February/March Newsletter and he or she will pick which question he or she wants to answer. The participant will inform the judge of his or her question and will then provide an answer. The judge is permitted to ask questions. No regional entry.

GAVEL GAMES

The 4-H Gavel Game is an activity designed to encourage youth to become more efficient in their ability to use parliamentary procedure effectively in the formal part of their 4-H club meetings.

GUIDELINES:**TIME LIMIT: 10 - 15 minutes**

1. This contest will consist of teams of four 4-H'ers: President, Vice President, Secretary and Treasurer.
2. Each team member will take a written test worth 30 points.
3. The division levels will be divided as Junior (7 to 13 years) and Senior (14 to 19 years). Each division will be judged on their parliamentary skills. If one or more 4-H'ers are in the Senior division, the team must enter as a Senior team.
4. Junior & Seniors levels may not use an order of business or notes.
5. Senior level **will** draw for Officer assignments. Junior level **will not** draw for Officer assignments.

***FCS Judging available from 9:00 a.m. - noon
located in the front hallway***

MODEL MEETING

The 4-H Model Meetings has been used as a device for teaching 4-H'ers proper meeting techniques. Clubs are encouraged to plan a Model Meeting that depicts a typical monthly meeting of their 4-H club. The meeting may be designed to suit the needs and interests of 4-H club members.

MODEL MEETING GUIDELINES:

The group may be composed of up to the number of 4-H members and leaders the room will hold.

An agenda of the Model Meeting must be presented to the judge before the meeting is called to order.

A maximum of thirty-five (35) minutes is allowed for a Model Meeting.

During the Model Meeting, the secretary should take notes. After the meeting, the secretary must turn in the Model Meeting notes and the up-to-date secretary's book.

Recreation may be at any time during the meeting. Some clubs prefer to have their recreation at the start of the meeting, rather than at the end.

Clubs are required to make at least one (1) motion from each of the five (5) categories of motions. The categories are: Main Motion, Subsidiary Motion, Incidental Motion, Privileged Motion, and Unclassified Motion. Motions can be found in the *A Guide to Parliamentary Practice for your club* on pages 2-3.

In addition to your club's usual meeting practices, references that may be used in planning a Model Meeting are:

The Meeting Will Come to Order - County Extension Office

Steps in 4-H Program Planning - County Extension Office

Out of Ideas? A Leaders Handbook - County Extension Office

For Model Meetings, clubs are required to make at least one (1) motion from the five (5) types of motions. This will result in a minimum total of 5 motions. The types of motions are: Main, Subsidiary, Incidental, Privileged, and Unclassified. Motions that fall under these categories/types can be found in *A Guide to Parliamentary Practice for your Club* on pages 2-3. This publication is available at the Extension Office.

All musical Entries must bring the original sheet music for the judge and have the measures numbered. **Vocal music participants must have their entry memorized. Instrumental music participants are not required to have their music memorized.**

NOTE: A piano or keyboard will be available for those participating in the instrumental and vocal music category.

The Lyon County Ambassadors will have concessions available during Club Days - snacks and drinks only.

Club Abbreviations

Busy Beavers	BB Model Boosters	MB
Cloverleaf	CL Reading	RD
Chamness	CH Rinker	RK
Happy Harvesters	HH Riverside	RS
Logan Avenue	LA Sunflower	SF

SENIOR GAVEL GAMES	
Time Limit: 10 to 15 minutes	
Regional Entry: 1	
Room: D4	Club: Logan Avenue
10:00	Logan Avenue - Ashlyn Align, Kaleb Catterson, Riley Botkin & Kaman Simmons
10:15	Happy Harvesters - John Fritts, Hanna Wecker, Jack Creager & Chance Redeker

JUNIOR GAVEL GAMES	
Time Limit: 10 to 15 minutes	
Regional Entry: 1	
Room: D4	Club: Logan Avenue
10:30	Cloverleaf - Garland Hanlin, Josie Orear, Kaylie McKay & Mattie Cork
10:45	Logan Avenue - Annika Douglas, Emily Storrer, Darby Hauff & Rose Catterson
11:00	Model Boosters 1 - Emily Miser, Wyatt Miser, Bailee Van Sickle & Kasen Van Sickle
11:15	Model Boosters 2 - Morgan McCoy, Kelsey McCoy, Kinzie Kurzen & Jaiden Kurzen
11:30	Riverside—Trevor Barnett, Mason Gibson, Taylor Pringle & Bethany DeDonder

Each Gavel Game Team must report to room D2 to take the written test. Due to scheduling conflicts, this may be done before or after your Scheduled Gavel Game.

MODELING MEETING
Time Limit: 35 Minutes
Regional Entry: 1

Room: B2 - Gym

Club: Happy Harvesters

9:00	Cloverleaf	CL
------	------------	----

DANCE
Time Limit: Not to Exceed 5 minutes
Regional Entry: 1

Room: B2 - Gym

Club: Happy Harvesters

12:00	Emily Miser & Josie Orear	MB/CH
-------	---------------------------	-------

NOVELTY
Time Limit: Not to Exceed 5 minutes
Regional Entry: 1

Room: B2 - Gym

Club: Happy Harvesters

12:15	Reading 4-H Club	RD
12:25	Douglas Family	LA

SHOW & SHARE
Time Limit: Not to Exceed 2 minutes
Regional Entry: 0

Room: C4

Club: Chamness

10:45	Ty Karcher	CH
10:50	Addisyn Williams	HH
10:55	Drew Ritchie	HH
11:00	Lane Wilson	BB
11:05	Korbin Reeves	RS
11:10	Hunter Senft	RD
11:15	Grayson Hanlin	CL

SENIOR INSTRUMENTAL SOLO
Time Limit: Not to Exceed 5 minutes
Regional Entry: 1

Room: C2

Club: Riverside

9:00	Kaci Duggan	LA
9:05	Karis McAllister	RS
9:10	Katie Laws	BB
9:15	John Pringle	RS

JUNIOR INSTRUMENTAL SOLO
Time Limit: Not to Exceed 5 minutes
Regional Entry: 1

Room: C2

Club: Riverside

9:20	Kate Rees	CH
9:25	Lily Skalsky	BB
9:30	Blake Skalsky	BB
9:35	Hope McAllister	RS
9:40	Kyla Kuhlmann	HH
9:45	Taylor Pringle	RS
9:50	Leo DeDonder	RS
9:55	Bethany DeDonder	RS
10:00	Landon Reeves	RS
10:05	Dilynn Reeves	RS
10:10	Spencer Fox	LA
10:15	Kerstyn Fox	LA
10:20	Rachael Coppock	RD
10:25	Robert Jones	RD
10:30	Hanna Jones	RD
10:35	McKinley Senft	RD
11:40	Rowdy Orear	CH

INSTRUMENTAL ENSEMBLE

Time Limit: 10 minutes

Regional Entry: 1

Room: C2

Club: Riverside

10:45	McAllister Family	RS
10:55	Mason Jenkins & Brayden Sweet	RS

SENIOR VOCAL SOLO

Time Limit: 10 minutes

Regional Entry: 1

Room: C2

Club: Riverside

11:05	Ashlyn Alingh	LA
-------	---------------	----

SENIOR DEMONSTRATIONS

Time Limit: 10 minutes

Regional Entry: 2

Room: C11

Club: Busy Beavers

9:00	Leiah Annett	CH
9:10	Madelynne Douglas	LA
9:20	Caleb Catterson	LA
9:30	Chance Redeker	HH
9:40	Viola Fritts	HH
9:50	John Fritts	HH
10:00	Damon Redeker	HH
10:10	Elleana Bennett	MB
10:20	Ted Skalsky	BB
10:30	Ashlyn Alingh	LA
10:40	Karis McAllister	RS
10:50	Karlee Wigton	BB

JUNIOR TALKS
Time Limit: 2 to 7 minutes
Regional Entry: 2 Total

Room: D5

Club: Reading (9:00-9:45) - Cloverleaf (9:45 - end)

9:00	Chloe Fischer	CL
9:06	Daylen Ballinger	CH
9:12	Isaac Knuth	CH
9:18	Maddie Knuth	CH
9:24	Braxton Farr	CH
9:30	Luke Marshall	CL
9:36	Josie Orear	CH
9:42	Rowdy Orear	CH
9:48	Bailee Van Sickle	MB
9:54	Kasen Van Sickle	MB
10:00	Taylor Pringle	RS
10:06	Mason Gibson	RS
10:12	Bethany DeDonder	RS
10:18	Cooper Spade	CL
10:24	Ava Karcher	CH
10:30	Leo DeDonder	RS
10:36	Cordon Olson	MB
10:42	Blake Redeker	HH
10:48	Ava Matile	SF
10:54	Hope McAllister	RS
11:00	Garland Hanlin	CL
11:06	Kaylie McKay	CL
11:12	Karsen McKay	CL
11:18	Rose Catterson	LA
	Continued on next page	

JUNIOR TALKS (continued)**Time Limit: 2 to 7 minutes****Regional Entry: 2 Total****Room: D5****Club: Reading (9:00-9:45) - Cloverleaf (9:45 - end)**

11:24	Kylee Barr	RD
11:30	Landon Reeves	RS
11:36	Dilynn Reeves	RS
11:42	Mason Jenkins	RS
11:48	Makenna Hoelting	HH
11:54	Annika Douglas	LA
12:00	Darren Heins	HH
12:06	Kinley Heins	HH

PUBLIC SPEAKING**Time Limit: 7 to 15 minutes****Regional Entry: 2****Room: C11****Club: Busy Beavers**

11:00	Leiah Annett	CH
11:15	John Pringle	RS
11:30	Marley Heins	HH
11:45	Madelynne Douglas	LA
12:00	Kaman Simmons	LA

JUNIOR DEMONSTRATIONS**Time Limit: 10 minutes****Regional Entry: 2****Room: C10****Club: Model Boosters**

9:00	Addison Marshall	CL
9:10	Josie Orear	CH
9:20	Rowdy Orear	CH
9:30	Jonas Kern	CH
9:40	Russell Kern	CH
9:50	Rose Catterson	LA
10:00	Rees Spade	CL
10:10	Austin & Cooper Woodrow	CL
10:20	Kylee Barr	RD
10:30	Emily Miser	MB
10:40	Wyatt Miser	MB
11:00	Makenna Hoelting	HH
11:10	Mason Jenkins	RS
11:20	Annika Douglas	LA
11:30	McKinley Senft	RD
11:40	Crue Jackson	RD
11:50	Caden Jackson	RD
12:00	Alycia Granado & Addison Wigton	BB

READINGS
Time Limit: Not to Exceed 5 minutes
Regional Entry: 1

Room: C4

Club: Chamness

9:00	Kate Rees	CH
9:05	Clara Traffinesteadt	CH
9:10	Jonas Kern	CH
9:15	Russell Kern	CH
9:20	Jesse Kuhlmann	HH
9:25	Leo DeDonder	RS
9:30	Bethany DeDonder	RS
9:35	Taylor Pringle	RS
9:40	Annika Douglas	LA
9:45	Cordon Olson	MB
9:50	Elleana Bennett	MB
9:55	Josie Orear	CH
10:00	Brayden Sweet	RS
10:05	Alyssa Skalsky	BB
10:10	Daden Wilson	BB
10:15	Jade Wilson	BB
10:20	Emmalie Bess	BB
10:25	Kerstyn Fox	LA
10:30	Spencer Fox	LA
10:35	Kylee Barr	RD

